



- Suitable for high requirements of anti-corrosion places, such as food and pharmaceutical industry, ships and offshore platforms.
- 303.316 or duplex stainless steel are all optional upon request.
- Torsionally flexible, maintenance-free.
- Light mass, small moment of inertia.
- Damping impact and vibration.
- Axial plug-in, fail-safety.
- All over machining-good dynamic properties.
- Maximum torque of elastomer is twice of the rated torque.
- Mounting instructions at 03.101.

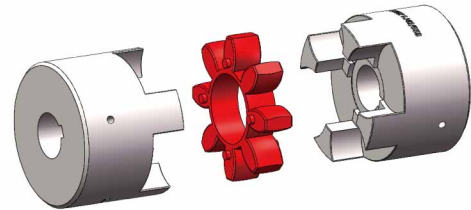
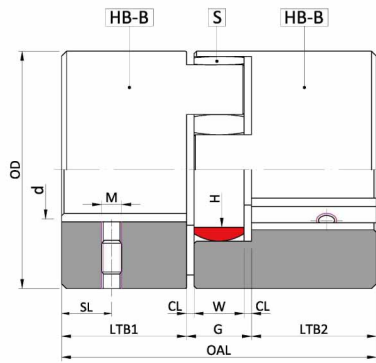

Fig 03.43

Size	Hub	Spider Rated Torque N.m			Dimensions mm							Set Screw			
		92ShA	98ShA	64ShD	d	OAL	LTB1-LTB2	G	W	CL	OD	H	SL	M	T _A
14	B	7.5	12.5	16	0-16	35	11	13	10	1.5	30	10	5	M4	1.5
19	B	10	17	21	0-25	66	25	16	12	2.0	40	18	10	M5	2.0
24	B	35	60	75	0-35	78	30	18	14	2.0	55	27	10	M5	2.0
28	B	95	160	200	0-40	90	35	20	15	2.5	65	30	15	M8	10
38	B	190	325	405	0-48	114	45	24	18	3.0	80	38	15	M8	10
42	B	265	450	560	0-55	126	50	26	20	3.0	95	46	20	M8	10
48	B	310	525	655	0-62	140	56	28	21	3.5	105	51	20	M8	10

- D is the bore diameter; The metric bore according to ISO fit H7. The feather keyway according to DIN6885 sheet1-JS91. The inch bore is in accordance with AGMA9002-C14 standard, the bore is clearance fit, and the keyway is commercial grade.
- Hexagon socket set screws with cup point is accordance with DIN EN ISO4029, stainless steel material, property class 21H. T_A is tightening torque, unit: Nm.
- More size details, please contact RUVJAX.